

LOfx LUMA SERIES

Low Voltage Linear Luminaire

Building upon the benefits of the LO, the LOfx adds a variety of optical solutions for beam sculpting to serve the specific needs of a venue...

Manufactured in America and constructed of a sturdy powder coated aluminum housing, the LOfx utilizes industry leading optics to deliver superior lumen output in an attractive low-profile package. Available in both standard output and high output, the LOfx includes onboard 0 – 10 V_{DC} dimming and can be mounted in either a fixed or articulating position to deliver the optimum desired solution for nearly any linear application.

Appropriate for dry environments, with a damp option available, the LOfx satisfies the most demanding needs for specifiers around the globe. Adding optical elements to the outstanding feature set makes it apparent why LOfx has been chosen by specifiers for low profile and broad light distribution applications repeatedly.

Features

- Made in America quality and craftsmanship
- Five CCTs and four colored LED standard options
- Customizable fixture lengths, CCT and CRI available
- Powder coated, low profile aluminum extrusion for seamless integration
- Fixed and articulating mounting options
- Fixtures can be daisy chained to form a longer run and energized from a single driver
- Multiple beam sculpting lens options
- Onboard 0 - 10V_{DC} dimming circuitry

Mechanical Profile & Compliance

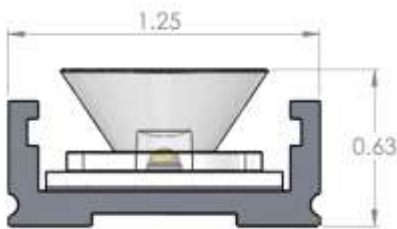

- All dimensions in INCHES



| Specifications | | | | | |
|-----------------------------------|---|-------|-------|-------|-------|
| CCT | 2700K | 3000K | 3500K | 4000K | 5000K |
| LED Pitch | 2" | | | | |
| Lumen Output | | | | | |
| SO | 444 | 444 | 445 | 513 | 594 |
| HO | 564 | 565 | 568 | 655 | 772 |
| CRI | 80+ & 90+ | | | | |
| Beam Angle | 15°, 40°, 50x10° | | | | |
| Lens | None | | | | |
| Dimmable | Yes | | | | |
| On Board Dimming | Yes | | | | |
| Construction | Aluminum & Plastic | | | | |
| Housing | White Powder Coated Aluminum | | | | |
| Fixture Length _{Min} | SO 5" HO 5" | | | | |
| Fixture Length _{Max} | SO 102" HO 96" | | | | |
| Ordering Increments | 1" | | | | |
| Daisy-Chain Capable | Yes | | | | |
| Power Consumption _{W/Ft} | SO 7W HO 10W | | | | |
| Efficacy _{LM/W} | | | | | |
| SO | 63 | 63 | 64 | 73 | 85 |
| HO | 56 | 57 | 57 | 66 | 77 |
| Power Supply | Class II | | | | |
| Operating Voltage _{DC} | 24V | | | | |
| Fixture Connectors | Indoor PlugnGo, Outdoor PlugnGo, Flying Leads | | | | |
| Fixture Mounting | Fixed Mounting Clip, Articulating Mounting Clip | | | | |
| Environmental Rating | Dry | | | | |
| Certifications | UL | | | | |
| Warranty _{Limited} | 5 years | | | | |
| Product Dimensions _{WxH} | 1.25 x 0.63 in | | | | |
| Operating Temp Range | -40 to 140 °F | | | | |
| Storage Temp Range | -40 to 180 °F | | | | |
| Weight | 0.60 lb / ft | | | | |

Specifications subject to change without prior notification

Ordering Information

Example: LOF-37S-835-40-LE-IRE-AM

| Product | Length ¹ | Output | CRI ² | Color | Beam Angle | Ingress Cable Orientation | iPosition | Termination ³ | Ingress Opposite Orientation ⁴ | Egress Cable Position | Mount |
|---------|---------------------|----------|------------------|--|-------------------|---------------------------|------------------------------------|--------------------------|---|--|---|
| LOF | ## | SO HO | 80+ 90+ | 27 30 35 40 50 RED GRN BLU AMB | 15 40 50x10 | Left Right | End Back Nearside Farside | IPG OPG | Right Left | X - None End Back Nearside Farside | FM - Fixed Mount AM - Articulating Mount |

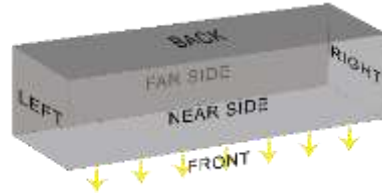

¹ Fixture length in inches, ² CRI does not apply to Colors; leave blank ³ Indoor PlugnGo, Outdoor PlugnGo or Flying leads ⁴ Will always be the opposite letter of the Ingress Cable

Mounting Clips

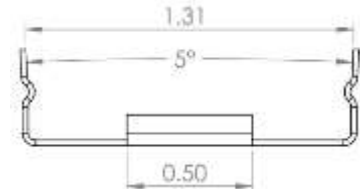
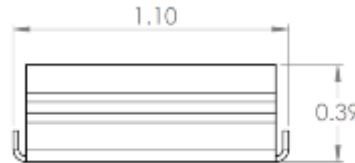
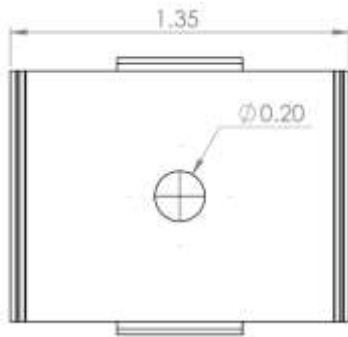

Fixed Mounting Clip

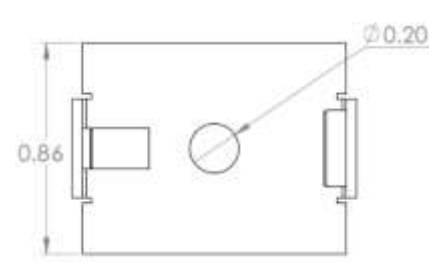
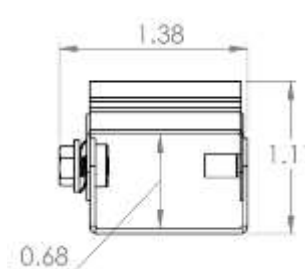
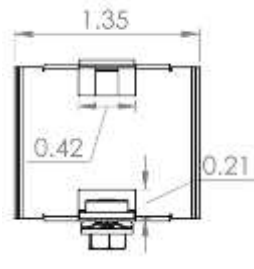
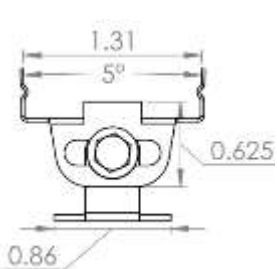

Articulating Mounting Clip

- All dimensions in INCHES

Dimming

The Luma Series of products are designed with a built-in dimming circuit that requires a 0 - 10 V_{DC} sinking dimming controller to properly function. Either a third party sinking dimmer controller can be used or one of two available options in the LEDdynamics LVD Series of products.

